

VersaPass® Best Practices

- HOW TO STORE A PRINthead
- HOW TO REPLACE A PRINthead
- HOW TO HANDLE A PRINthead



VERSAPASS™



Beautiful Precision, Simplicity, and Affordability.

CONTENTS:

About VersaPass Technology 3

How to Store a Printhead 4

STORAGE DO'S & DON'TS

ENVIRONMENTAL CONDITIONS

HANDLING GUIDELINES: THINGS TO AVOID

How to Replace a Printhead 9

HANDLE AND UNPACK THE PRINthead

REMOVE ORANGE CAP

REMOVE FILMS

STEPS TO INSTALL PRINthead

How to Handle a Printhead 15

HANDLING DO'S & DON'TS

ENDLESS POTENTIAL

The VersaPass Memjet printhead has been carefully designed and rigorously tested. For best performance and maximum life, optimize printhead health by following best practices around proper care of the nozzles.



PART 1

HOW TO STORE A PRINthead PROPERLY

When it comes to best practices for storage, the following steps are crucial to maximizing printhead life.

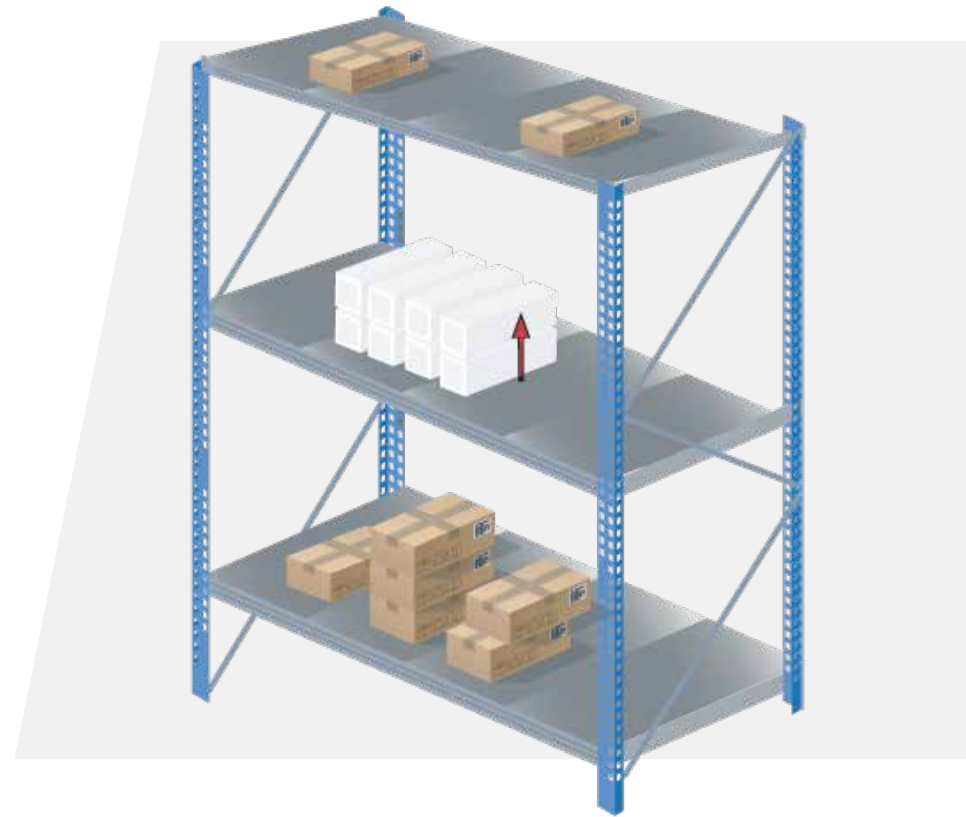

HOW TO STORE

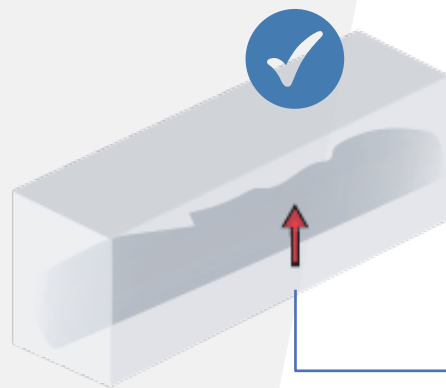
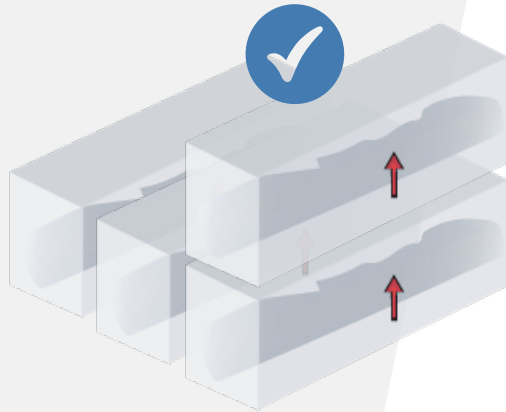

STORAGE DO'S

When storing a printhead, you'll want to make sure the printheads are kept flat with the orientation arrow pointing up (nozzles in the box are pointed down).

FOLLOW THESE GUIDELINES:

- Keep in original packaging and sealed until installed.
- Keep inside the box on a horizontal axis.
- Keep in box with nozzles pointing down and arrow on the outside of box pointing up.

HOW TO STORE

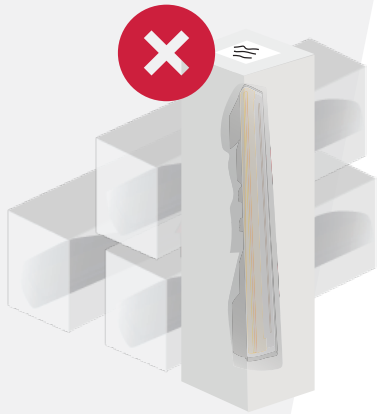

STORAGE *DON'TS*

Ignoring these guidelines can lead to dehydration, color mixing, nozzle contamination, and permanent damage to the printhead.

FOLLOW THESE GUIDELINES:

- Don't open sealed foil pouch UNTIL ready to install.
- Don't store upright and opened.

Avoid uncoverable dehydration

ENVIRONMENTAL CONDITIONS

To avoid print quality (PQ) issues and premature printhead end-of-life due to dehydration, nozzle contamination or permanent damage to the printhead, please follow these guidelines for optimal operating temperature and relative humidity.

WHEN? During storage¹, handling and operation.

WHY? Cleanliness, hydration (humidity) and temperature (dehydration) of printhead nozzles matter.

¹ Storage temperature: 5 - 45°C/41 - 113°F
Storage relative humidity: 5% - 95%

OPERATING TEMPERATURE

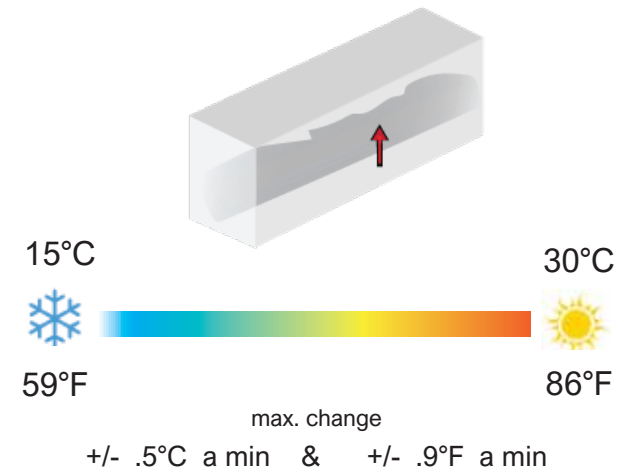

OPERATING RELATIVE HUMIDITY

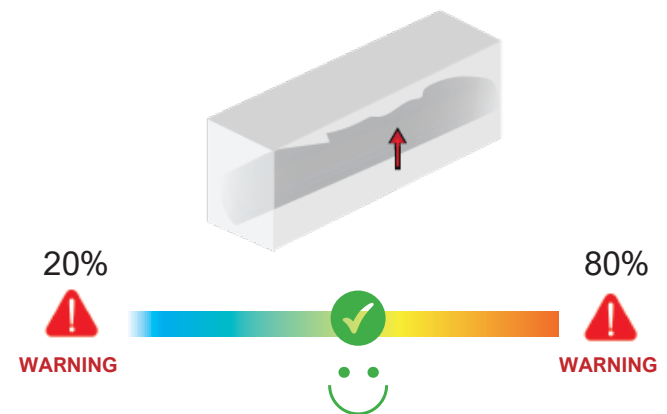

HANDLING GUIDELINES: THINGS TO AVOID

Damage to the printhead caused by drops or excessive vibration is often difficult to see without a time-consuming and in-depth analysis of the printhead.

Optimal print quality depends on proper care and use within the intended specifications and application maintenance requirements.

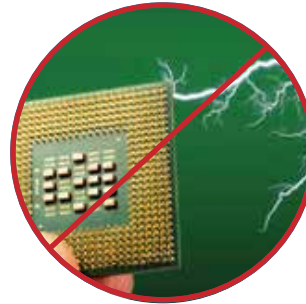

DO NOT TOUCH CONTACTS

Electro Static Discharge (ESD) sensitive – you can be zapped or cause damage

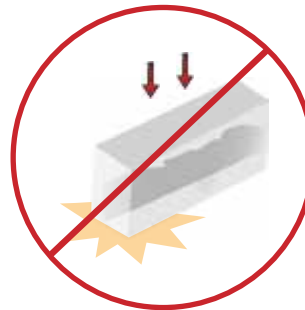

DO NOT DROP

Shocks, drops, and knocks can crack, break and damage printhead components (i.e. dies, resistors, electrical connections).

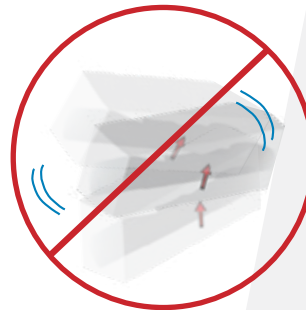

DO NOT SHAKE

Shaking and excessive vibration can cause internal air bubble formation, drooling or air gulping.

PART 2

HOW TO REPLACE A PRINTHEAD

Follow these step-by-step instructions to correctly install a printhead in your printer.



STEP 1: HOW TO HANDLE A PRINTHEAD

- Remove printhead from box.
- Tear open sealed foil pouch and remove printhead.

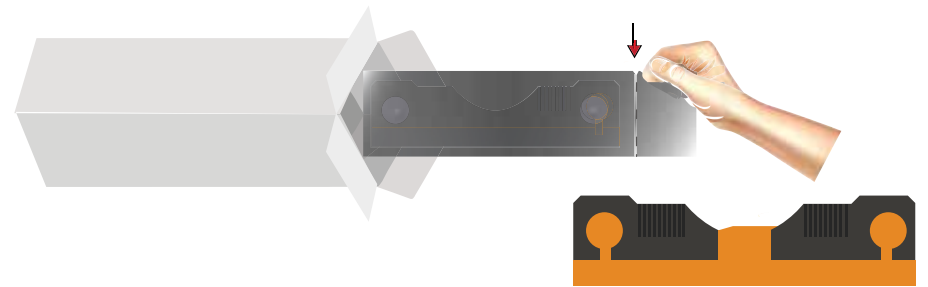

We recommend installing the printhead within 60 seconds of opening the sealed foil pouch.

STEP 2: REMOVE ORANGE CAP

- Unsnap orange cap.
- Remove orange cap, while holding onto middle handles.

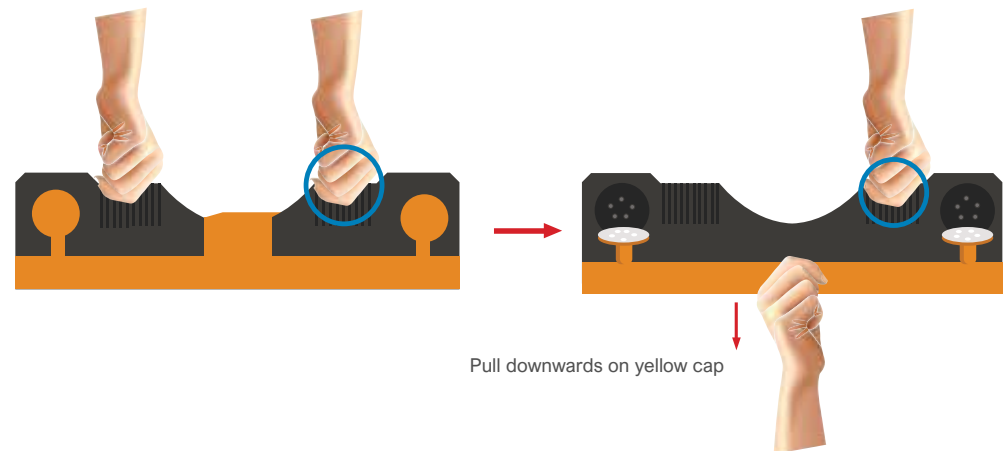

STEP 3: REMOVE BOTH FILMS BY PULLING OFF WHITE STICKER

- Remove protective film pulling on white tab.

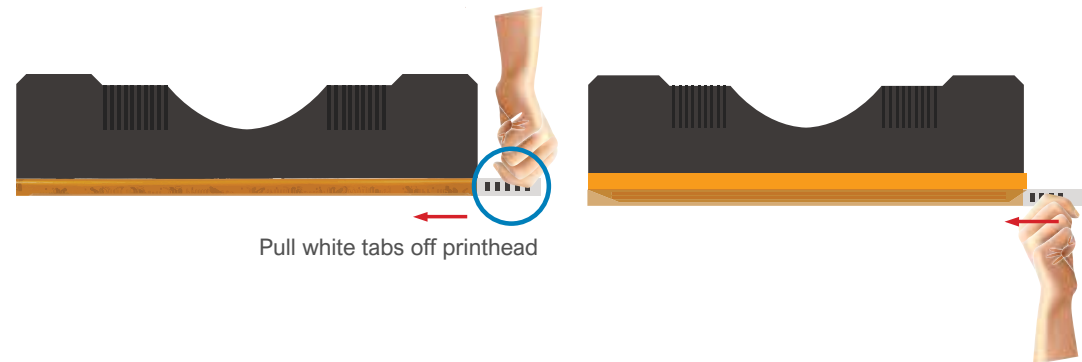

STEP 4: INSTALL PRINTHEAD USING 6 SIMPLE STEPS



1
Unsnap orange printhead caps.



2
Do not touch any part of the electrical contacts or ink ducts.



3
Take printhead out of orange cap and hold on handles for next step.



4
Hold printhead at 45° angle.



5
Place in at 45° angle and push back. Make sure it locks into place. You will hear a “click.”



6
Close blue latch until it clicks.

HOW TO REPLACE A PRINthead

AND FINALLY

Do not remove the printhead until it is time to replace it again. The printer will periodically service the printhead, optimizing print quality and printhead life.



PART 3

HOW TO HANDLE A PRINthead

For optimal performance, follow the advice on the next pages for handling printheads.



CORRECT PRINthead HANDLING

- Use a clean orange protective cap when outside the printer.
- Hold the printhead ONLY by the handles to avoid contamination and damage.

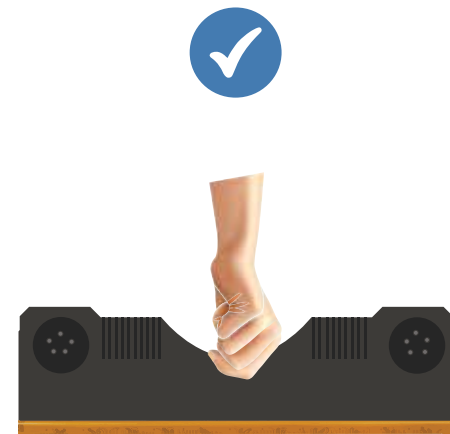
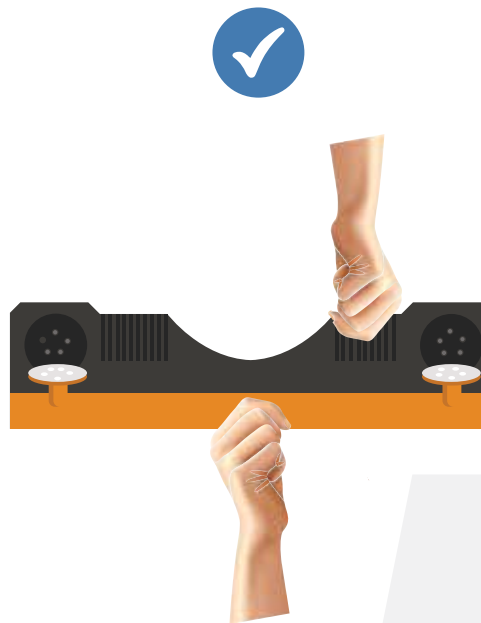
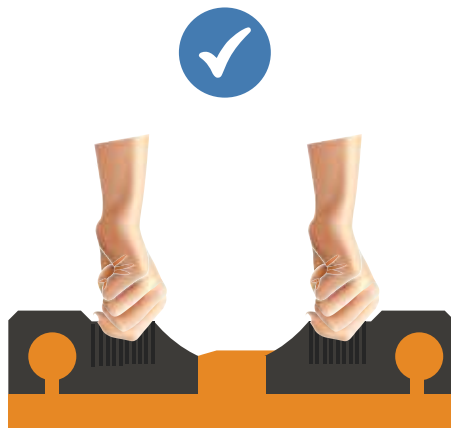

INCORRECT PRINthead HANDLING: THINGS TO AVOID

- Do NOT touch the ink couplings, nozzle surface or electrical contacts.
- Do NOT hold right side up as ink will run and cause problems.
- Do NOT hold printhead upside down.

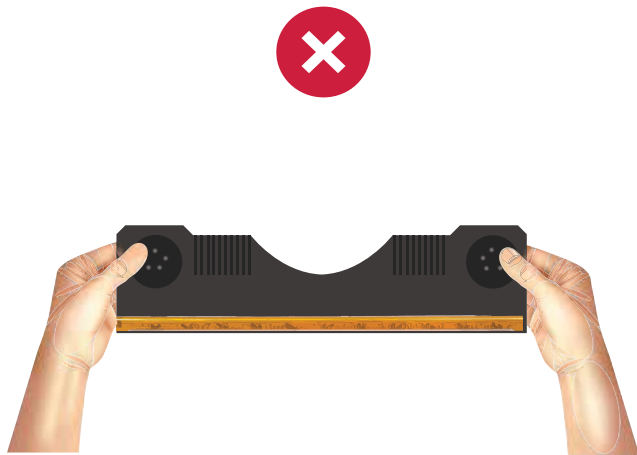

DO NOT handle the printhead in any of these ways.



*FOR MORE VERSAPASS TECHNOLOGY BEST PRACTICES,
OR TO PROVIDE FEEDBACK ON THIS RESOURCE:*

Visit www.memjet.com/versapass-resources



Follow us on LinkedIn [@memjet-technology](https://www.linkedin.com/company/memjet-technology)

